

Instructions

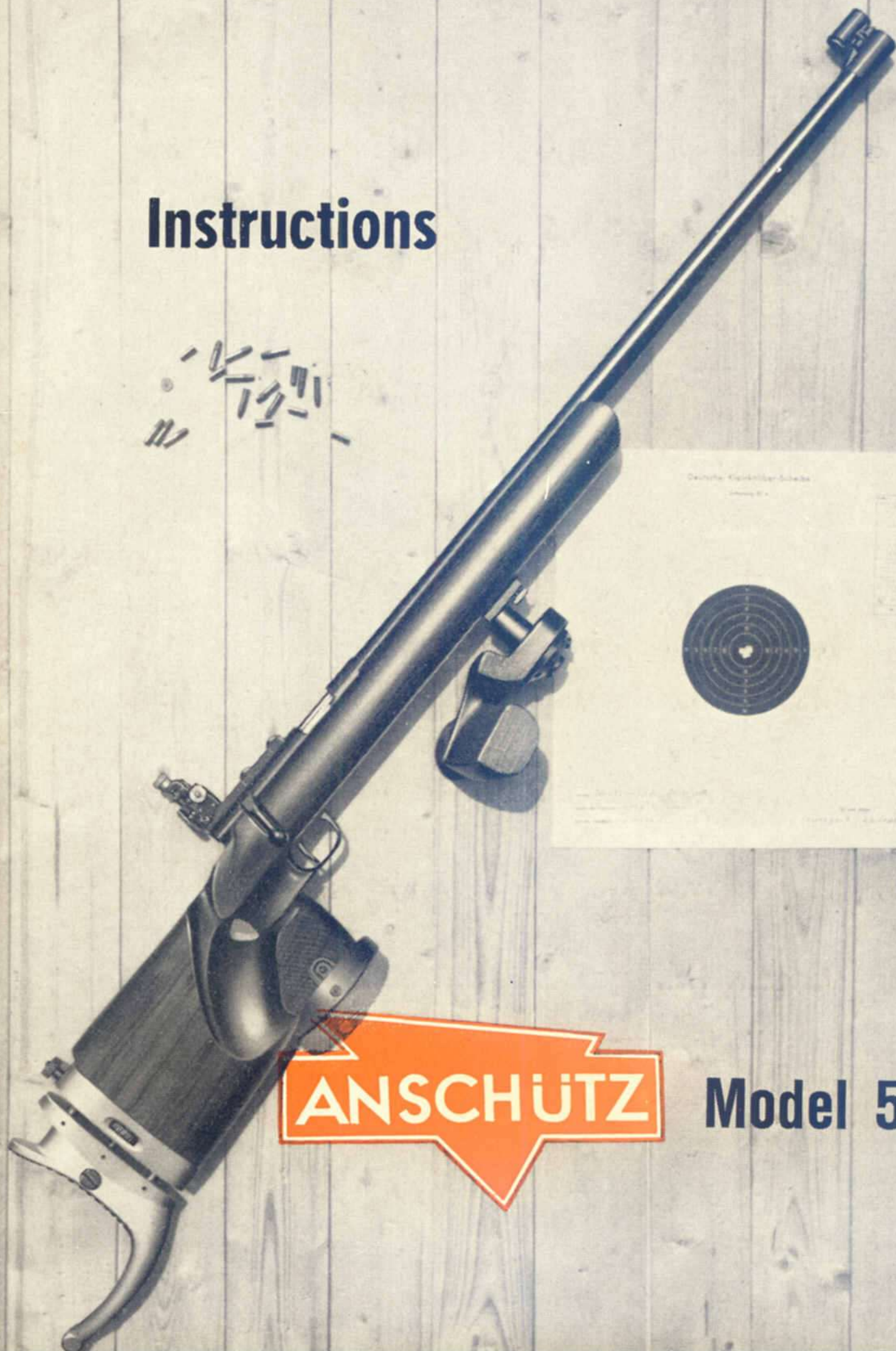

ANSCHÜTZ

Model 54

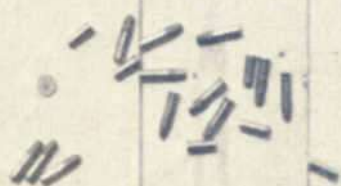

Model 54

Serial No.

40187

Name of Owner

Place

Street

Important Notes

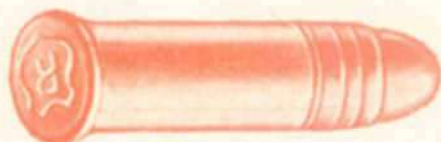
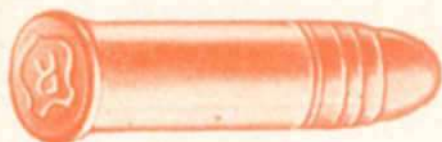

Dear Shooter



After the many successes in national and international matches, it surely was not difficult to decide on an Anschütz Match Rifle. You will have a lot of fun and if you concentrate, as a successful shooter must, you will follow in the footsteps of the leaders in this game of skill.

As you know it is not the rifle but the shooter who must do the job. This booklet is meant to give you some useful hints in order that you may become more familiar with your Model 54 Anschütz Match Rifle. By learning the operation and the proper care of your rifle, you and your Anschütz become a team. Please remember that we are behind you as far as the performance and precision of your Anschütz rifle is concerned. If you take care of your rifle, it will enable you to reach the winning scores you desire.

Therefore "Good Luck"



from J. G. Anschütz

Index

2	Index
3	Decades of Labor
4	The barrel — The Stock
5	Match Triggers
6	How to disassemble the Bolt
7	How the Reassemble the Bolt
8	Anschutz Micro Sight with scale
9	Adjusting the Micro Sight
10	Zero Setting of the Special Micro Sight
11	Anschutz Microsight and adjustment
12	Accessories
13	Front Sight and Extension
14	Two Rifles using one stock
15	Small Bore Rifle Care
16	Zimmerstutzen Care
17	Anschutz Match Air Rifle
18	Spare Parts List for Mod. 54
19	The Anschütz Action Mod. 54
20	Notes
25	Anschutz Rifles and their Success

**ANSCHÜTZ**

Decades of Labor

It has taken many years of collecting professional know how to reach this goal. The great love for rifle competition has made the Anschutz Rifle what it is today. Many long hours and sleepless nights have been spent so that every desirable design feature could be tested and retested.

We can now say, with humble pride that Anschutz manufactures the worlds best known match rifles. For this we are thankful to the men and women who are doing such a fine job at our plant. Your Anschutz rifle is the result of dedicated craftsmen, years of experience, and the finest steel in the world.

The Anschutz Barrel

The barrel steel used by Anschutz is of the best grade especially selected for Rifle barrels. Such are of maximum weight which allow a balance of the rifle which is very much in its favor and give such fine accuracy never thought possible up to now. Each one has 8 Lands of the most exact sculpture and all standard .22 cartridges of any reliable make will give good results. Many Gun editors have mentioned this in their reports to the Shooter.

Below shows actual size 50-shot group fired at 50 meters (55 yards) at the International Small-Bore Target. Such groups are routine for Anschutz-Model 54



The Anschutz Buttstock

Only well seasoned walnut will go into a stock for your Anschutz Rifle. Stock length, Shape, Cheekrest and the anatomic pistol grip are the result of many years of tests by prominent Shooters. Particular attention was given to different size of men, as well as various shooting positions. All stocks are rubbed down and oiled but not polished. A polished stock will slide too easy and a scratch will show up at once. A few drops of oil rubbed in from time to time is always a good idea.

The Anschutz 2-stage HAIR Match trigger No. 1404-U8

The ANSCHUTZ 2-stage hair match trigger requires two adjustments: By loosening (anti-clockwise) or tightening (clockwise) the trigger spring adjustment screw No. 28, the length of travel of the first stage can be shortened or lengthened accordingly. By means of the trigger pull lever screw No. 25 the degree of engagement of the catch link No. 23 in conjunction with the catch No. 27, can be adjusted. By loosening screw No. 25 (anti-clockwise) the sensitivity is reduced and by tightening (clockwise) increased. At the ultimate point of engagement the sear is held at only a few 1/100 mm. However, it should be noted that too fine an adjustment will cause uncertainty of cooking and if reversed will cause drag and creep of the trigger. Trigger No. 20 may be moved for accommodation of a small or large hand.

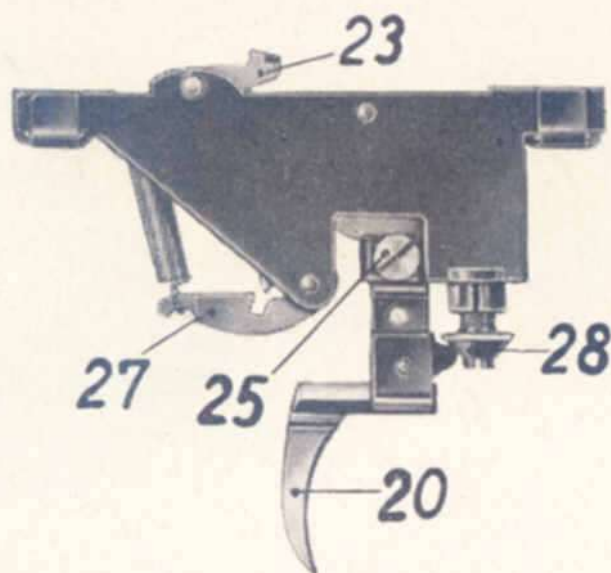

The Anschutz 3 lbs one stage Match trigger No. 1411-U8

Each 3 lbs trigger is factory regulated to a pull of 3 lbs. To increase the weight of pull turn screw No. 28 clockwise. To remove the creep of the trigger, it has to be adjusted in the opposite way like two stage hair trigger.

Trigger No. 20 may be moved for accommodation of a small or large hand.

The Anschutz combined double set/single trigger mechanism No. 5039

The combined double set/single trigger has two possibilities. It can be used as a supersensitive single trigger and also as a 2-stage hair trigger, in the latter case the adjustment being the same like the normal ANSCHUTZ 2-stage hair Match trigger. Using the single trigger only the adjustment is as follows: Push trigger level No. 20a forward the trigger level 20 is set and ready for use.

To increase sensitivity, the trigger spring adjustment screw No. 28 must be turned anti-clockwise. It is advisable to turn this screw so far that the trigger goes off by itself- then turn screw clockwise by a quarter turn to produce a very fine pull. Trigger No. 20 may be moved for accommodation of a small or large hand.

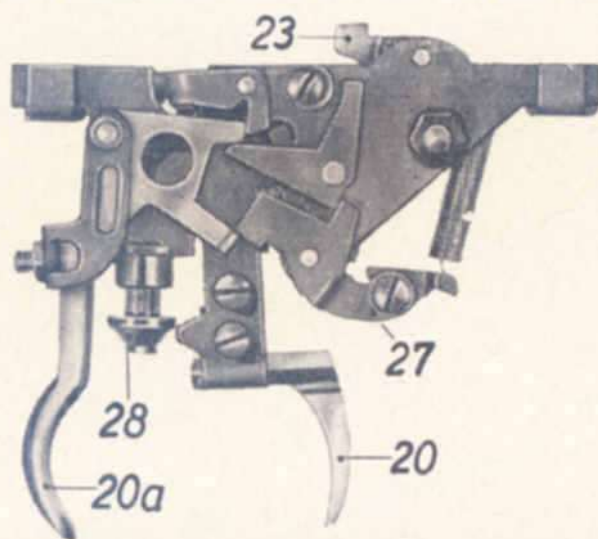



1

A

How to disassemble the Bolt

1. Push back on left side of stock the bolt stop and remove bolt (Illustration No. 1)
2. Turn counterclockwise bolt handle and the safety in opposite directions as per illustration No. 2.
3. Hold bolt upright, pull out all parts towards the top as illustration No. 3 and 4.

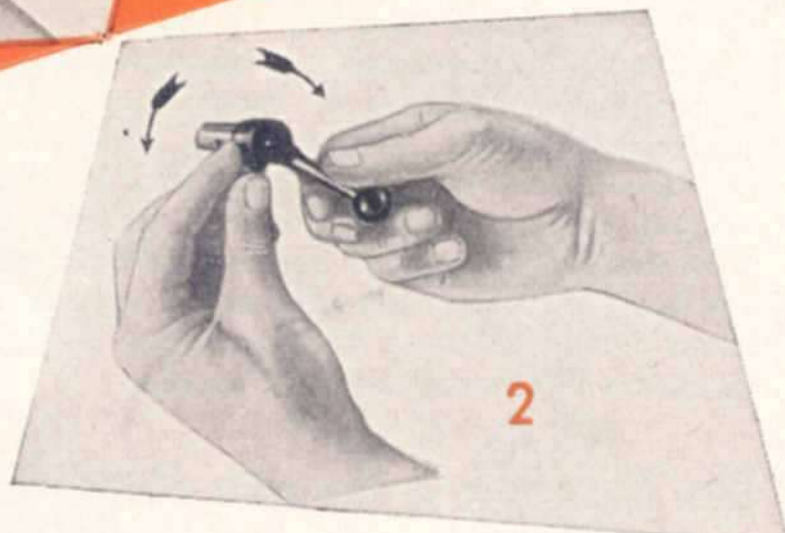

2



3

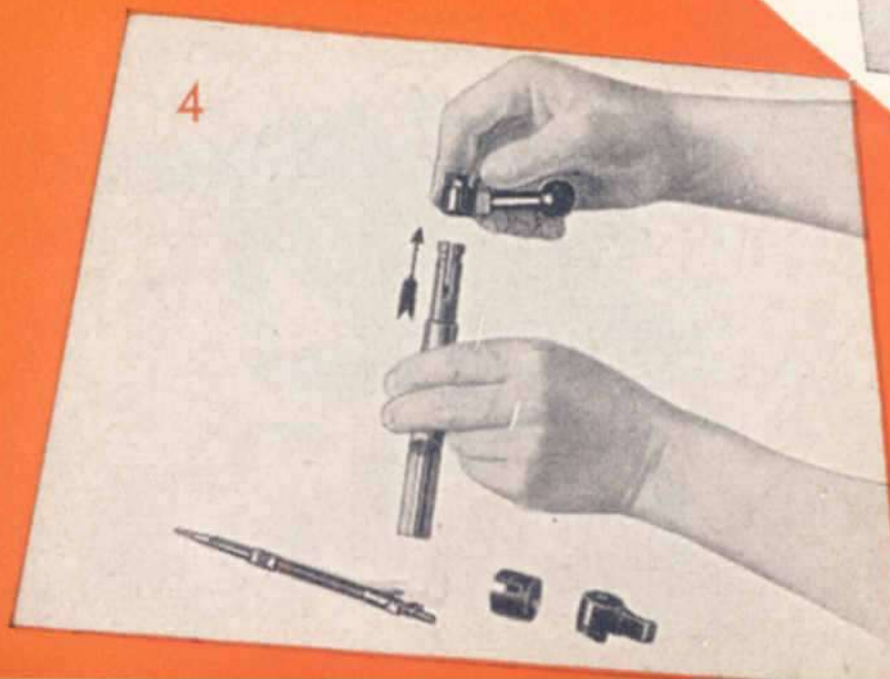

4

The Bolt

The Anschutz Lock has been kept purposely heavy and is of the finest construction. The bolt and cam are ground in to give it that satin feeling when in motion and has two locks. The wing safety locks the firing pin and also the bolt handle. When safety is in safe position the bolt cannot be opened. The firing pin is kept as light as possible and travels at lightning speed over the shortest space for instant ignition.

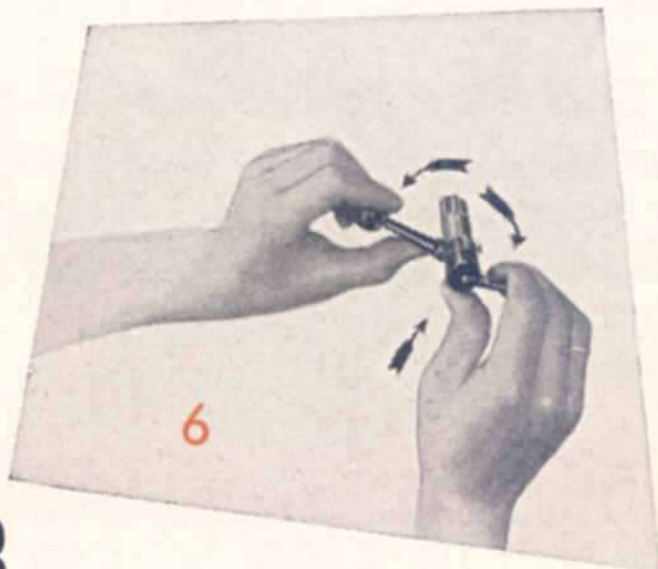

B

Re - Assembling of Bolt

There assembling is accomplished by following the procedure reversed as stated under A.

- A. Put bolt handle back in place, make sure the locking pin enters in the second notch to keep the slot in the firing pin free (see illustration 5).
- B. Put firing pin in place.
- C. Put Bolt nut with safety in place, pull safety and bolt handle apart and push safety down (see illustration No. 6).

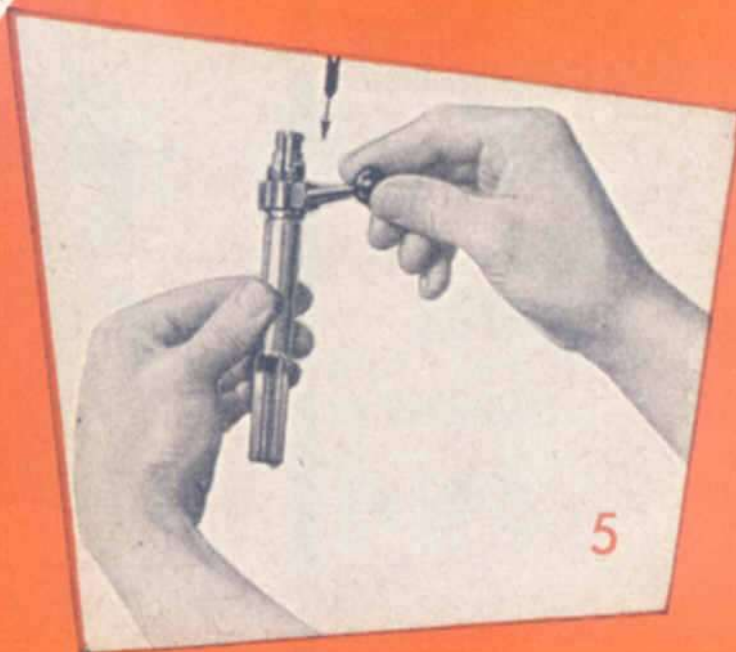

The Anschütz Micro Sight

For the Anschütz Match Rifle there is a choice of 2 sights the No. 6702 Micro sight with scale or the Micro sight No. 6700. The rear sight is mounted on a rail which slides on the grooved receiver bridge. Two knurled pressure screws are provided for locking the rail to the receiver. The receiver sight is adjustable to obtain desired eye-distance.

Peep sight discs may be had with various apertures such as 1,1 and 1,2 m/m diam. Any other size may be ordered special. The small size is recommended for strong light and the larger one when less light is available.

ANSCHÜTZ

No. 6702

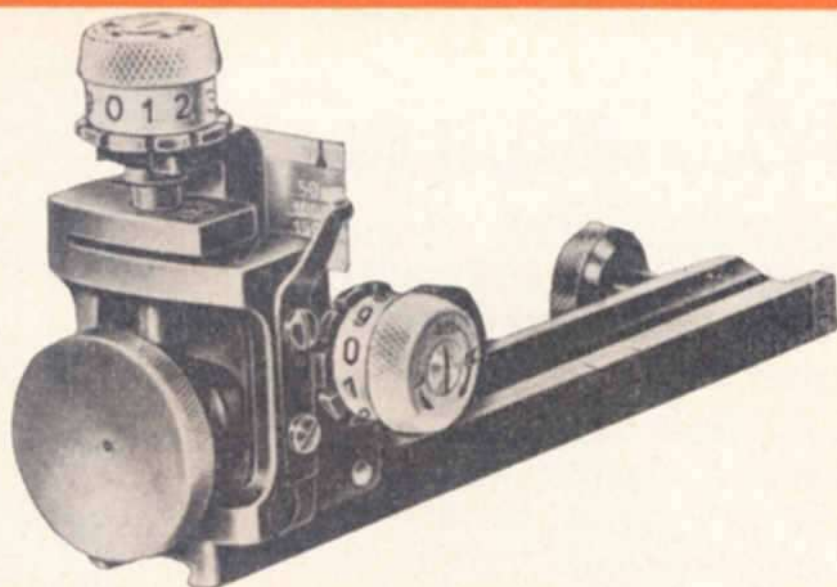

For best results we recommend the No. 6702 Anschütz Special Micrometer Sight with scale preferable to use in connection with the new INTERNATIONAL SMALL BORE Target.

Adjusting the Micro Sight

How to adjust the Anschutz Micro Sight No. 6702. It is a well known fact that the Anschutz No. 6702 holds its adjustment due to its precise click arrangement from click to click

at 50 meters about 2,5 m/m per click adjustment ($\frac{1}{6}$ minute)
at 100 meters about 5 m/m per click

If shot
is high turn
elevation
screw to
the right.

If shot
is low turn
to the left.

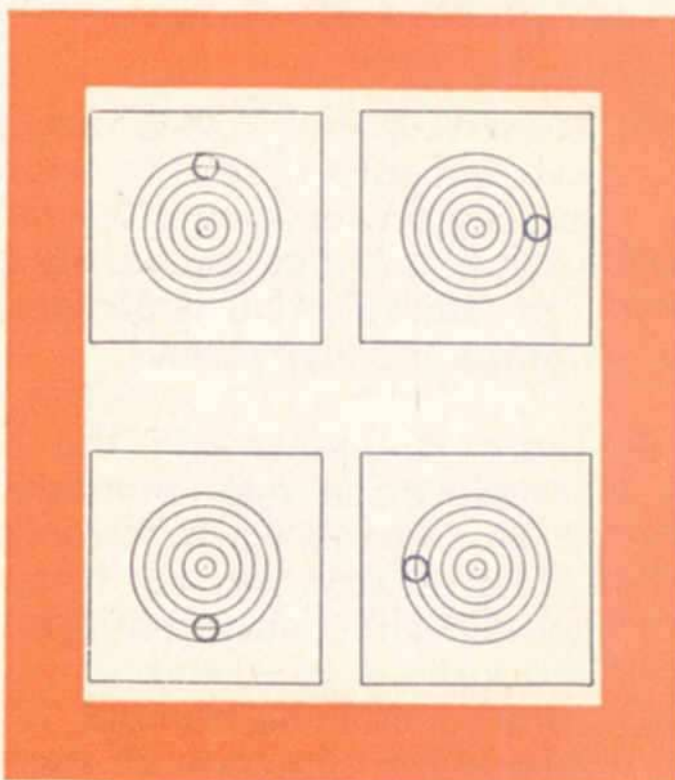

If shot
is to the right
turn windage
screw to right.

If shot
is to the left
turn
to the left.

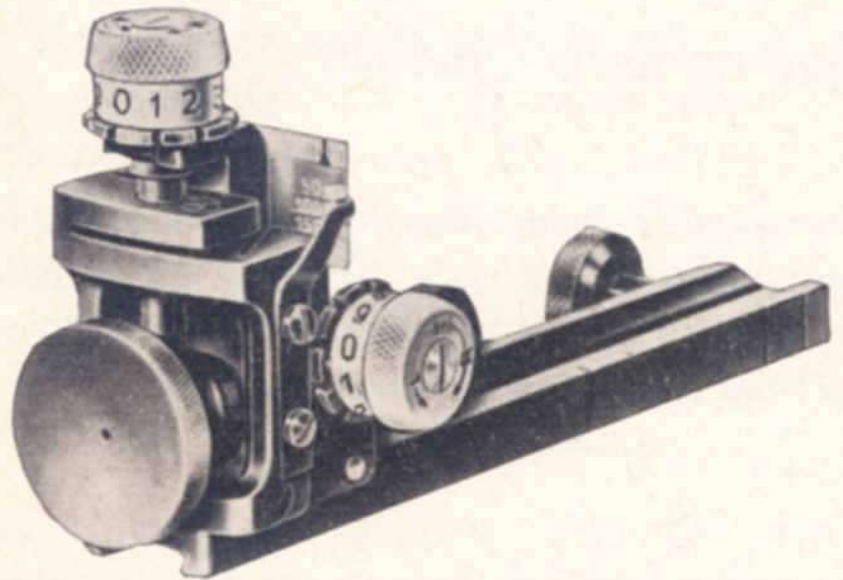

Zero Setting of the Micro Sight

At normal weather — wind and light condition-target in your Anschütz at Dead Center. Then proceed as follows:

- A) Loosen up the 2 retaining screws of the two indicators, set the windage indicator exactly on the centerline marking and the elevation indicator exactly at the distance (For Example if it is 50 Meters on 50) and tighten the lock screws.
- B) There is underneath the Knurled Knobs for elevation and windage a lock screw to be opened up sufficiently to allow the lifting of both Knurled Knobs to be turned without click, easy setting.
- C) Turn so that the number "0" (Zero) is visible in the direction of the shooter, allow Knob to drop back.
- D) Tighten up both lock screws.

Now your Micro Sight is zeroed in for Normal shooting range.

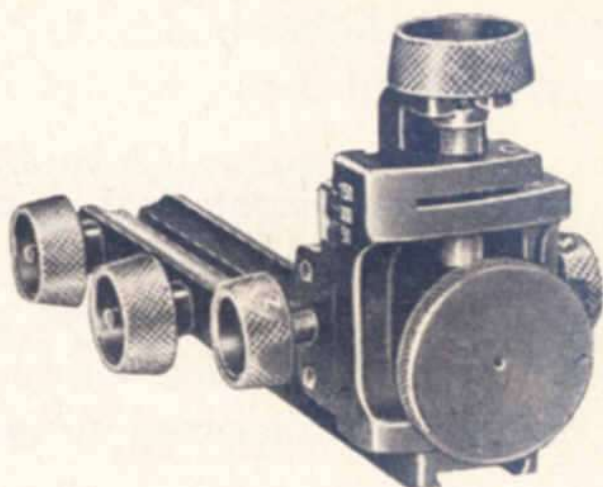

No. 6700

ANSCHÜTZ

Anschutz Micro sight No. 6700 adjustment. The No. 6700 is a precision instrument of fine quality.

1) **Elevation** the adjustment knob has stops. From stop to stop there is at 50 meter 2,5 m/m and at 100 meter 5 m/m elevation difference.

2) Windage is controlled by two Knurled set screws working as a team. This eliminates any change of the sight setting not wanted. These two set screws have 6 surfaces. From surface to surface are to be figured a change of 2,5 m/m for 50 meters distance and 5 m/m for 100 meters. In between setting can be made as found necessary as there are no clicks. If the rifle shoots to the right, release left screw and tighten up the right side screw and the same reversed procedure if rifle shoots to the left.

**Peep sight discs
No. 6700-5**



**Rubber disc
No. 6700-20**



**Orthocolor
Yellow Lens
No. 7860**



**Front Sights
Post Type
No. 6522-5**



**Front Sights
Aperture Type
No. 6522-3**



are available in various apertures. The most popular are 1,1 and 1,2 m/m and are always in stock. Other sizes on special order. The small aperture is for strong sunlight and larger one for poor light.

fits on to the peep sight steel disc. It has a grooved protection tube which the shooter is able to cut off groove by groove depending the length required. In the inside a optical lens or a yellow sunfilter may be set.

may be used in light or dark glass, if there is a blue sky or haze the target will show up much clearer. The yellow light filter can be put in place by using a clean piece of linen or soft leather.

has two types of interchangeable inserts one with a square post and one with a round aperture. The post type may be had in 5 different sizes 1,7, 2,0, 2,3, 2,6 and 3,4 m/m width. The round aperture sight can be furnished in sizes 1,7 to 5,5 m/m each 0,1 m/m more in size. However, experience has proved that such round apertures with a small hole are bad for the eye and do cause errors in Shooting. For this reason for 50 meters at the International Small Bore Target a round aperture should not be smaller than 3,5 m/m and for 100 meters 2,9 m/m.

The design of the Globe front sight serves as a front sight protector as well as a light control and the insert can be changed by releasing the lock screw. If the light is very strong two cylindrical extensions can be attached as illustrated. (Order No. 6525/26).

The Anschutz Spirit-Level

The ANSCHUTZ Spirit-level (for Front Sight 6522-1) enables the shooter to correct immediately his position before firing each single round.

The ANSCHUTZ Spirit-level is inserted into the Globe Foresight and can be easily turned in such a manner that when aiming with the rifle in a comfortable position the bubble of the spirit-level equalizes above the pointer. In this position the spirit-level is set by means of a careful turn of the screw "A" clockwise.

The Anschutz Iris

gives you 8 different apertures 0,8—1,7 m/m which gives you the facility to shoot under any light condition. You don't need to carry any further various discs as the Iris opens like a camera shutter and is always perfectly round due to its unique construction.

The Anschutz Sling Strap

for the Shooter so important may be had for right hand or heft hand. Through the setting of the loop which is covered with special rubber a firm grip of the arm sling is assured and makes it easy to make any further correction instantly and without any difficulty. Specially desirable for prone and in knee position shooting.

**Globe Front Sight
No. 6522-1**



**Anti-Glare Tubes
No. 6525/26**



Spirit-Level No. 6530



Iris-Disc No. 6711

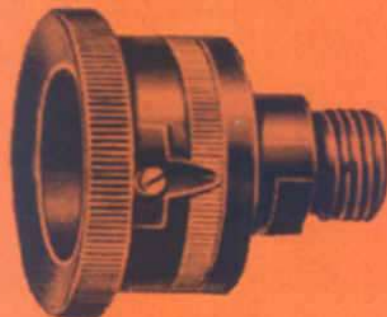

**Sling
No. 7400**



Two Rifles in one stock with Anschutz. 22 LR and Zimmerstutzen Barreled Action Cal. 4 mm

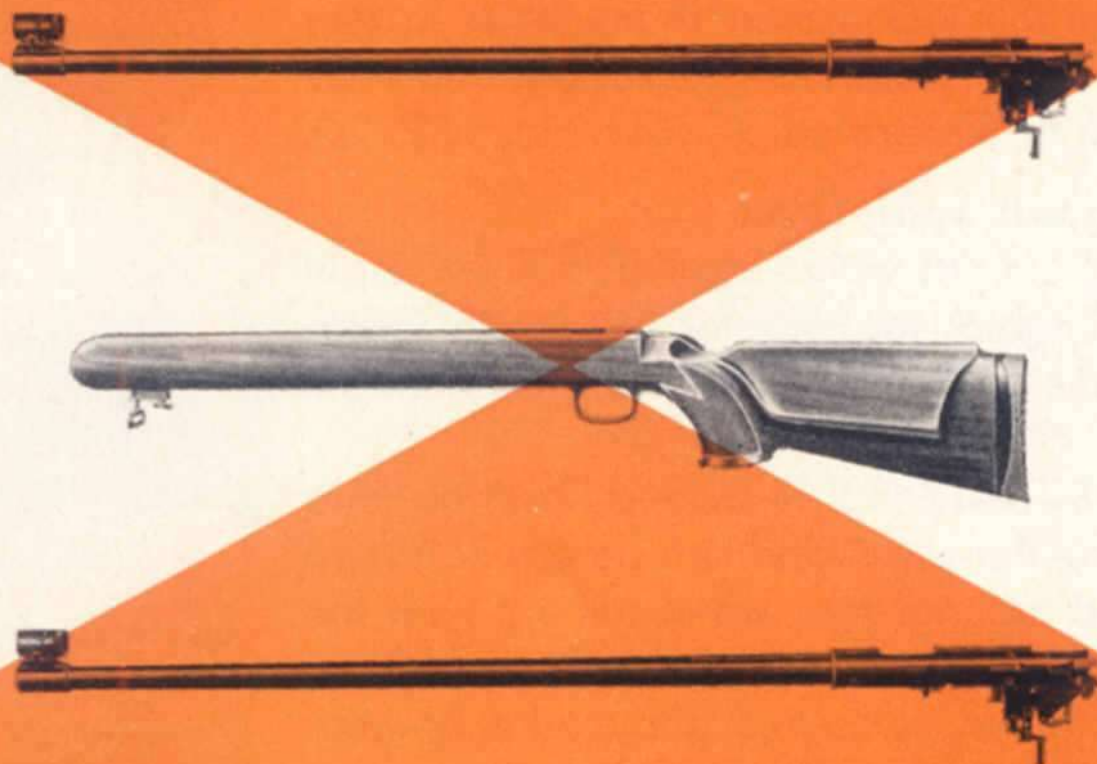

When you purchased an Anschutz Match Rifle you have become a member of the "Anschutz" System which gives you a further possibility to enlarge your selection of shooting equipment.

For Example

1. Purchasing an extra Super Match stock your Model 54 Match Rifle becomes a special rifle for participation in any International Matches.
2. The purchase of a Zimmerstutzen barreled Action will fit the same Buttstock which gives you an Indoor Match Rifle of the finest quality. There is simply nothing better anywhere.
3. The Anschutz Indoor Match Rifle also known as the Zimmerstutzen can be transformed instantly into a .22 LR Match Rifle by purchasing a Model 54 Match barreled action. The advantages are always the same fit, shooting all year around, same weight and sights. You save as you need only one set of sights. When changing over always make sure to tighten the rear assembly screw first, then the front assembly screw. Again in the same turn tighten both screws good and tight. Be sure that the top of front assembly screw and abutment plate are not in touch with the corresponding hole and rabbet of the action.

Small Bore Rifle Care



No. 4401 The Cleaning Rod Guide

ANSCHÜTZ

Before starting always dry swab the barrel of your Rifle. After you are through shooting it is always best to clean and oil your rifle. Remove the bolt, to avoid damaging it is always best to insert a cleaning Rod Guide as the No. 4401 illustrated above in the breech. If there is some Gun Flannel use it as otherwise it will not take the grooves properly. Push the cleaning rod forward until the beginning can be seen at the muzzle. In case you pushed the cleaning plug through all the way never try to pull back. Just dismount the plug and then withdraw the Rod. Renew patch until it stays clean, then spray on a few drops of good gun oil and swab the barrel once more. Never use steel or wire brushes, never scratch around in the barrel, always a full length stroke.



Zimmerstutzen Care

Again we advise to clean out the barrel and swab dry before starting to shoot. After you are finished shooting clean out the barrel of your Zimmerstutzen. We supply with each Zimmerstutzen a cleaning outfit consisting of

- 1 Cleaning Rod
- 1 Brass Brush
- 1 Bristle Brush
- 1 Rod Tip

Remove as above the bolt and insert a wooden cleaning Rod Guide No. 4401. The residues of the Zimmer ammo require a brass brush for cleaning then follow with a patch to remove whatever there is still left in the barrel. Follow up with an oil soaked patch. Never use steel brushes at any time.

The outside tube of the Zimmerstutzen barrel never needs cleaning as it has a slot underneath to allow escape for any residues.

ANSCHUTZ Match Air Rifle Mod. 220 Cal. .177 (4,5 mm)



1. No recoil on firing due to the new system of compensating compression. (Only after the pellet has left the barrel is the force of the plunger striking the cylinder wall noticed; thus giving the same feeling as shooting with a small bore target rifle.)
2. Distance between sights, $31\frac{1}{2}$ inches. Fixed barrel, the line of sight being always constant in comparison with a "breakdown" air rifle where the foresight is moved every time the rifle is cocked. The ANSCHUTZ micrometer peep-sight and tunnel foresight with elements, used with the ANSCHUTZ Model 54 small bore Target Rifles, can also be used with this Match Air Rifle. This is most economical for the shooter as the same set of sights can be used with both rifles.
3. The rifle is cocked by means of a lever placed at the side of the air chamber. By a patented control of compression a constant pull has been achieved thus eliminating fatigue to the arms and affording easy cocking whether in prone, kneeling or standing positions. So the ANSCHUTZ Match Air Rifle becomes the ideal training and Match weapon for 3-position competitions.
4. Easy to load by a self locking loading platform.
5. **Stock:** Same shape as the ANSCHUTZ Model 54 small bore target rifle, with long fore-end swivel plate for the sling swivel adjustment. It is also possible to use other accessories such as the palmrest, sling and interchangeable Hook heel plate etc.
6. An excellent match trigger mechanism positioned at a point for perfect balance. — Total weight: approx. $9\frac{1}{2}$ lbs. — Overall length: 45 inches.
7. It is unnecessary to lubricate the air chamber or plunger due to the use of new improved material.
8. The ANSCHUTZ Match Air Rifle is also available with cocking action and stock for Left-Handed shooters.
9. As a result of the excellent precision of the ANSCHUTZ Match Air Rifle, the method of loading and, design adapted from the ANSCHUTZ Mod. 54 small bore target rifle, the discriminating marksman has at last a perfect weapon for both Match and training purposes.

SPARE PARTS LIST FOR **ANSCHÜTZ** TARGET RIFLE MODEL 54 SUPER MATCH CAL. .22 LONG RIFLE

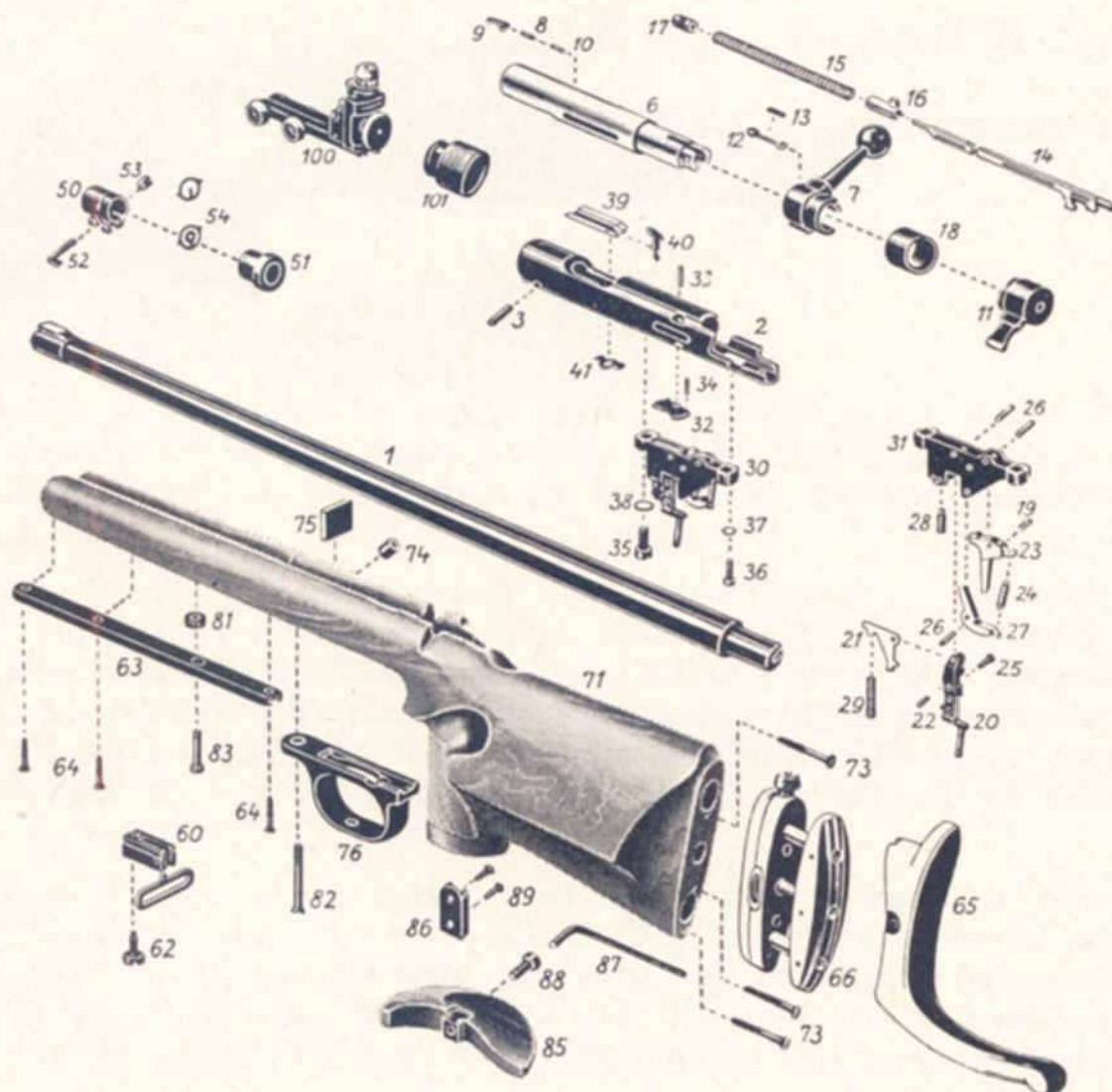

Item No.	Part
1	barrel
2	receiver
3	barrel retaining pin
5	bolt complete
6	bolt case only
7	bolt handle only
8	extractor pin
9	extractor
10	extractor spring
11	safety catch
12	bolt handle lock pin
13	bolt handle lock pin spring
14	firing pin
15	firing pin spring
16	firing pin spring rear guide
17	firing pin spring front guide
18	safety jacket
19	catch link spring
20	trigger
21	adjustment lever
22	stop pin
23	catch link
24	snap spring
25	trigger pull lever screw
26	hinge pin
27	catch
28	trigger spring adjustment screw
29	trigger spring
30	trigger mechanism assembly
31	trigger housing
32	bolt stop
33	bolt stop hinge pin
34	bolt stop hinge spring
35	receiver front screw
36	receiver rear screw
37	ratchet washer J 3,7
38	ratchet washer J 5,3
39	loading platform
40	ejector
41	ejector spring

Item No.	Part
50	front sight body
51	front sight lock ring
52	front sight lock screw
53	front sight lock nut
54	interchangeable front sights post type inserts 1,7 2,0 2,3 2,6 mm ring sight inserts 2,2 -4,5 mm each 0,1 mm larger
60	adjustable sling swivel
62	swivel lock screw
63	front swivel plate
64	front swivel plate wood screw
65	hook butt plate
66	buttend adjustable base for hook butt plate
70	stock Super Match style complete
71	stock Super Match style without fittings
72	adjustable butt plate with hook
73	butt plate mount screws
74	trigger adjusting screw housing
75	abutment plate
76	steel trigger guard
81	guide washer for front assembly screw
82	rear assembly screw
83	front assembly screw
85	hand rest with clamp piece
86	base for above
87	key size 6 mm hexagon style for No. 86
88	inner hexagon screw for above
89	wood connecting screw for handrest slide
6702	special peepsight with scale plate
6700.20	rubber eye shade
6700.5	disc with 1,0 - 1,5 mm peep hole, each 0,1 mm larger
4721	Super Match Action complete to interchange palmrest with universal adjustment
4722	palmrest with flattened out wood section
4723	palmrest with ball type bearing
4720	fixtures without wooden piece for palmrests
4730	handstop
4713	interchangeable rubber butt plate for prone position

The Anschutz Action Mod. 54

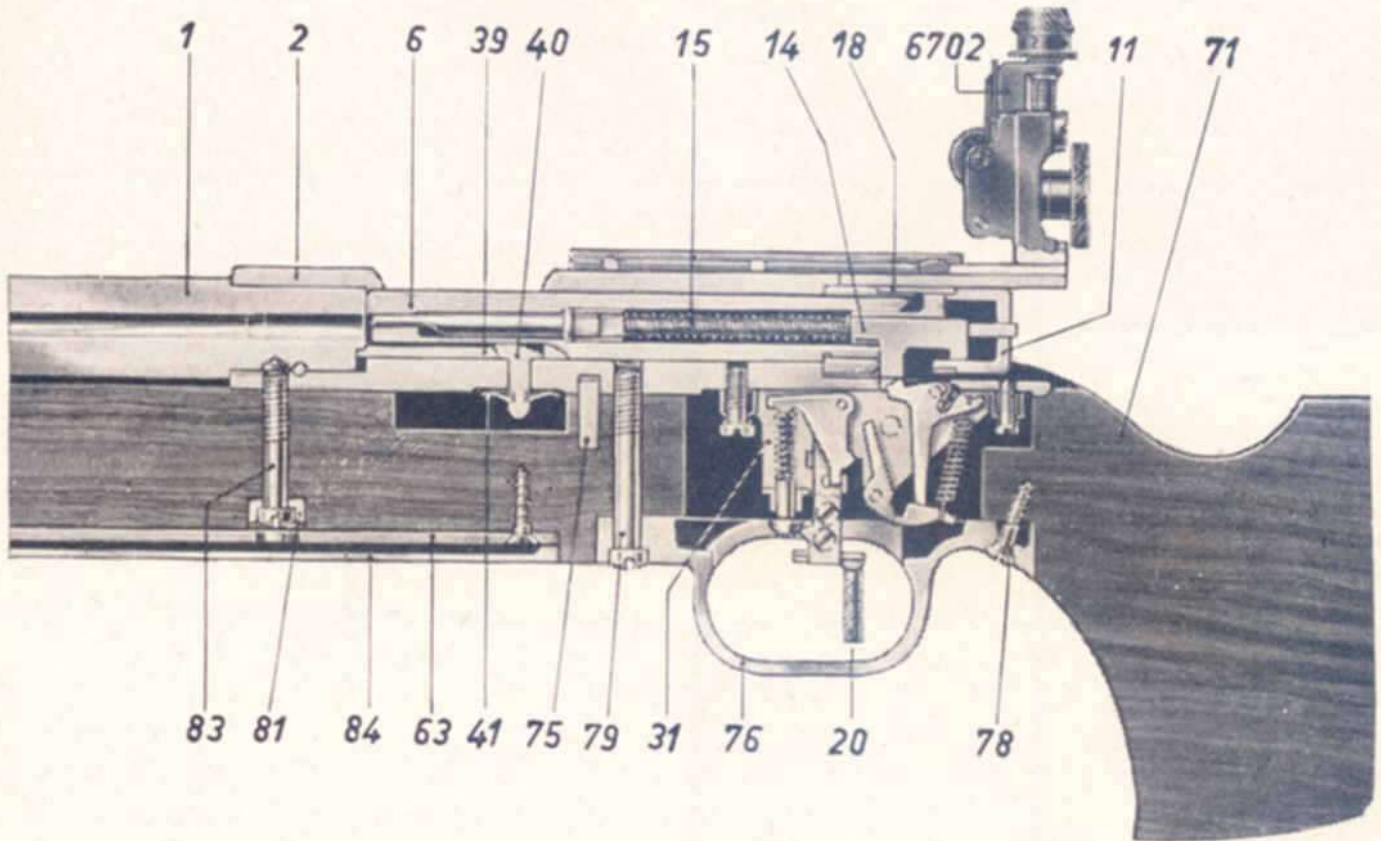

A Short Final Word

Having now become familiar with your new Anschutz Match Rifle, you are now ready to devote the many hours of practice which are necessary for you to reach the championship grade.

Take your time, practice with your friends or in your basement with the Zimmerstutzen insert. Consider our well intended instructions as an aid to your practice.

On the following pages keep a record of good and bad scores. In this way you can see your progress.

ONE MORE CAUTION! Never aim a rifle at anyone loaded or not. Follow the rules as established by your organization. Never aim at a bird, it is better to feed them in the winter.

AND ONE MORE REQUEST. Please tell your friends that you are satisfied with your Anschutz Model 54. In case you have any suggestion or improvements you want us to consider just let us know.

Once more LOTS OF LUCK!

Cordially yours

J. G. Anschutz

ANSCHUTZ rifles have proved their accuracy and excellent workmanship in many smallbore competitions throughout the world



World Championships 1958 in Moscow with ANSCHUTZ

**4 world championships in smallbore competition
further: 2 second places 4 third places**

European Championships 1959 in Milan with ANSCHUTZ

**3 world records
5 European Championships (Gold Medals)
4 Silver Medals
and many more other great successes**

Olympic Games 1960 in Rome

Half of the Smallbore Target Marksmen from all over the world shot in Rome with ANSCHUTZ

Olympic Match

Gold Medal	Germany	with ANSCHUTZ
Silver Medal	America	with ANSCHUTZ
Bronze Medal	Venezuela	with ANSCHUTZ

3-Position Match

Bronze Medal	Germany	with ANSCHUTZ
---------------------	----------------	----------------------

How can you miss with an



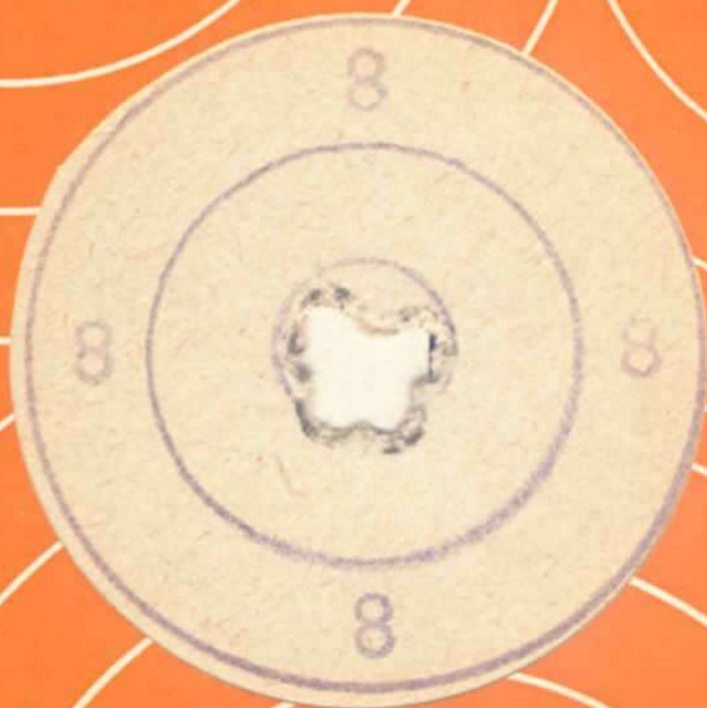

**Original Grouping
of your Rifle 10 Rounds at 50 Meters**